



EXHAUSTO

Modulating Damper MDF

Description

The EXHAUSTO MDF Modulating Damper is used to control the flow and pressure in a chimney system where the natural draft is excessive. It is used with an EXHAUSTO Model EBC 30, Modulating Pressure Controller, which makes up MODS, Modulating Over-fire Damper System.

Typical uses: 1) Individual over-fire draft damper for single boiler systems and 2) Common over-fire draft damper for multiple boiler systems.

Functions

The MDF is a ruggedly built multi-blade damper in stainless steel and equipped with a fast acting actuator attached to the damper shaft. The damper assembly has flanged connections and fits most types of Pressure Stack. It is of an opposed blade design to assure an extremely accurate control of the flow.

The actuator is a brushless DC driven microprocessor based actuator with conditioned feedback that operates on 24VAC. The motor delivers a min. 240 in.lb. or 27 Nm torque at rated voltage and is custom configured for the damper. The minimum duration through the 90° operating angle is 20 seconds. It is equipped with an Enerdrive System, a system that initiated by an interruption of the mains supply, engages and drives the motor at full torque to a fully open or closed position.

The MDF is available in sizes from 12"ID to 36"ID.

Material

The damper housing and the damper blades are made in 16 ga. type 304 stainless steel. The 1/2" damper shaft is of stainless steel and has stainless steel bearings. The assembly is designed for operating temperatures of up to 750°F (400°C).

Warranty

2-year factory warranty

Listings

Actuator is ETL listed

Damper meets AMCA Standard 500

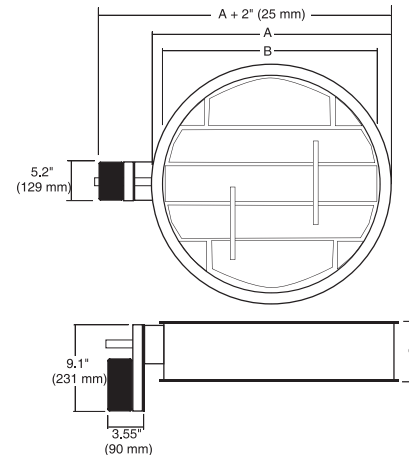

Specifications

Item #	Stack ID	Dia. A		Dia. B		C	
		in	mm	in	mm	in	mm
EXH2501	12	13.00	330	12.00	305	6.00	152
EXH2502	14	15.00	381	14.00	356	6.00	152
EXH2503	16	17.00	432	16.00	406	6.00	152
EXH2504	18	19.00	483	18.00	457	6.00	152
EXH2505	20	21.00	533	20.00	508	6.00	152
EXH2506	22	23.00	584	22.00	559	6.00	152
EXH2507	24	25.00	635	24.00	610	6.00	152
EXH2508	26	27.00	686	26.00	660	6.00	152
EXH2509	28	29.00	737	28.00	711	6.00	152
EXH2510	30	31.00	787	30.00	762	6.00	152
EXH2511	32	33.00	838	32.00	813	6.00	152
EXH2512	34	35.00	889	34.00	864	6.00	152
EXH2513	36	37.00	940	36.00	914	6.00	152
EXH2514	42	43.00	1092	42.00	1067	6.00	152
EXH2515	48	49.00	1245	48.00	1220	6.00	152

Specifications are subject to change without notice.